

NEW FORCE CONTROLLER

Precise adjustment of force controlled setting equipment



BOLLHOFF

FORCE CONTROLLER – Precise adjustment of force controlled setting equipment

Operation



1 Installation of tooling

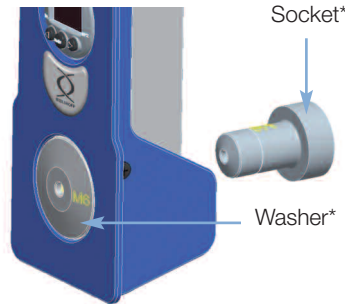

*Tooling kit, see below

2 On & Off Switch



Delivered with two 9V 6LR61 batteries

3 Spin on + Pull up



4 Measurement

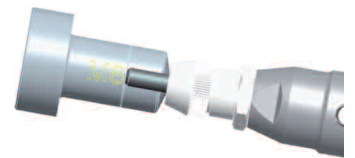

Characteristics

- Article code: 282 522 14 000
- Measuring range: 0 → 40 kN
- Preciseness: ± 3%
- Usable dimensions: M3 → M16
- Tooling available in various diameters
- Delivered with protective case, without tooling*

*Space for 4 tools

Benefits

- Easy to use:
- **Cycle the tool → See the force value**
- No adjustment required
- Compatible with all existing force controlled setting equipment

5 Reading the value

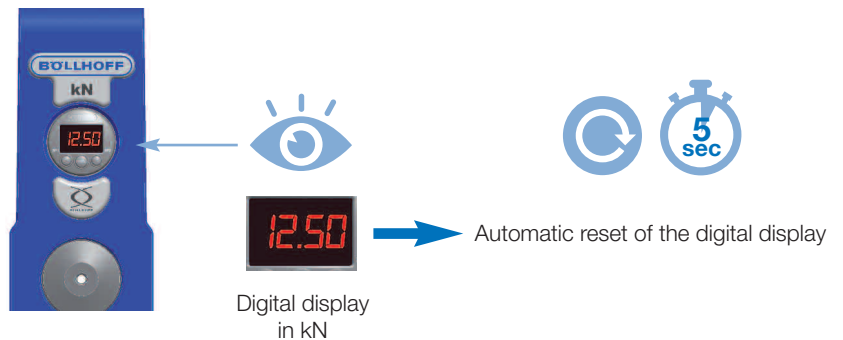

RIVKLE® tooling kit

		Ø TOOLING KIT										
		Cod.	M3	M4	M5	M6	M8	M10	M12	M14	M16	
	Standard	282 522 14 1XX	03	04	05	06	08	10	12	14	16	
	Stud	282 522 14 XXX	-	M4	M5	D5	M6	D6	M8	D8	M10	
			-	204	205	505	206	506	208	508	210	

Tooling for RIVKLE® UNC and RIVKLE® UNF available on demand.
Select the kit according to the diameter you use.



Bollhoff Olatu s.a. · Fastening technology
Rue Archimède · Z.I. de l'Albanne · B.P. 68 · F-73493 La Ravoire cedex.
Tél. 04 79 96 70 00 · Fax 04 79 96 70 11
www.bollhoff.com/fr · E-mail : info_fr@bollhoff.com